



**BMX SUPERCROSS
WORLD CUP**

**MANCHESTER
GREAT BRITAIN**

Competition Guide

2019 UCI BMX Supercross World Cup

Manchester (Great Britain)

27 – 28 April



CONTENTS

1. WELCOME & INTRODUCTION	3
2. GENERAL INFORMATION	4
3. REGISTRATION	5
4. TEAM BIBS.....	7
5. RIDER ACCREDITATION	7
6. TEAM MANAGERS MEETING.....	7
7. EVENT SCHEDULE	8
8. TEAM AREAS	9
9. UCI OFFICIALS	9
10. TRAVEL & ACCOMODATION INFORMATION	10
11. ABOUT MANCHESTER	18
APPENDIX 1 – VENUE LAYOUT	19
APPENDIX 2 - TEAM AREA BOOKING FORM.....	20

1. WELCOME & INTRODUCTION

On behalf of British Cycling, UK Sport and Manchester City Council, I am delighted to welcome you to the HSBC UK National Cycling Centre for the first two rounds of the 2019 UCI BMX Supercross World Cup series.

We are excited to be welcoming back the world's premier BMX series to this iconic venue – the home of British Cycling - after a three-year break.

Since we last hosted a UCI BMX Supercross World Cup, the track has undergone a significant transformation, which will deliver the highest possible level of competition and help to add to the legacy of the event by providing a first-class training and competition facility for the entire community.

As the sport's national governing body in Great Britain, we have a responsibility to not only deliver the highest quality elite events, but also to ensure that the events, the thrill of high-level competition and the inspiration provided by the riders serves to encourage more and more people onto their bike.

We hope that the chance to see the world's best BMX athletes competing here will continue to inspire people to take part in the sport.

This competition guide should provide you with all the information you need to enter the UCI BMX Supercross World Cup and plan your journey to the event in Manchester. Should you require further information or have any questions please contact the organising team on bmxsuperox@britishcycling.org.uk.

Thank you for being part of what we anticipate will be a fantastic event. We look forward to welcoming you to Manchester.

Jonathan Rigby

Commercial Director

British Cycling

Join, follow and share the 2019 UCI BMX Supercross World Cup – Manchester

- Facebook: <https://www.facebook.com/BMXSuperX>
- Twitter [@BMXSuperX](https://twitter.com/BMXSuperX)
- Official website is <https://www.britishcycling.org.uk/bmxsxworldcup>



2. GENERAL INFORMATION

The UCI BMX Supercross - Manchester will take place at the HSBC UK National Cycling Centre in Manchester. The facility is a fantastic purpose built indoor BMX track and sits alongside a new mountain bike trail and Manchester's famous velodrome as the home of British Cycling.

The venue is situated in the Etihad Campus adjacent to the junction of A6010 Alan Turing Way and A662 Ashton New Road. Please note that ALL road direction signs are for the HSBC UK National Cycling Centre.

HSBC UK National Cycling Centre
Stuart Street
Manchester
M11 4DQ
England

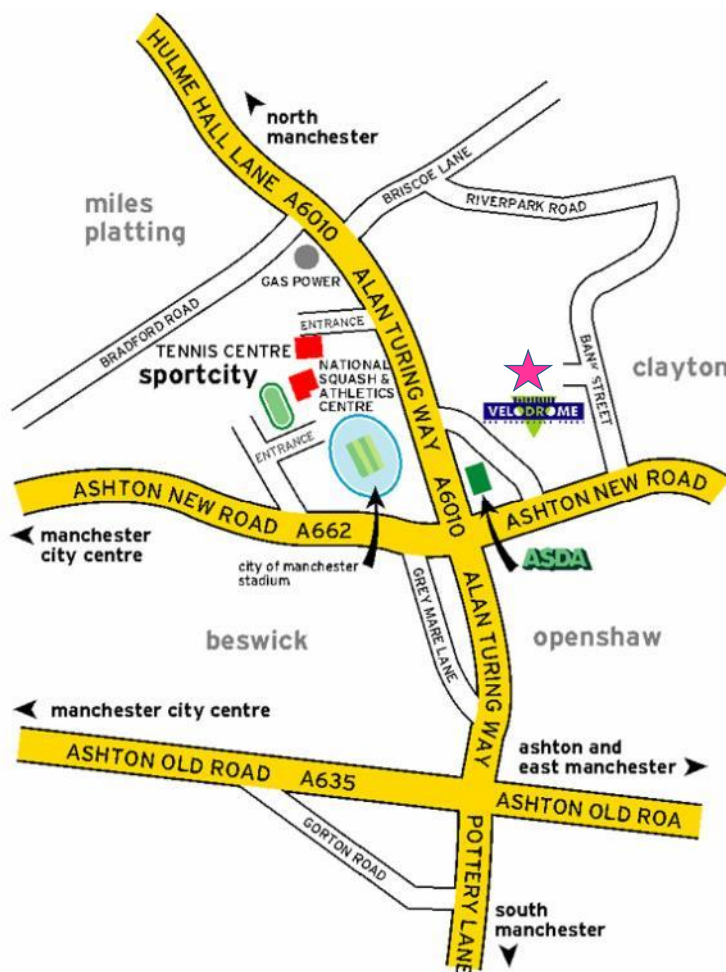

3. REGISTRATION

You can enter through the UCI website clicking as follows:

- **Web services** (on the homepage on the right side, last link)
- **UCI World Cups**
- **“Riders registration”**

Access: personal login and password of each National Federation or UCI BMX Team.

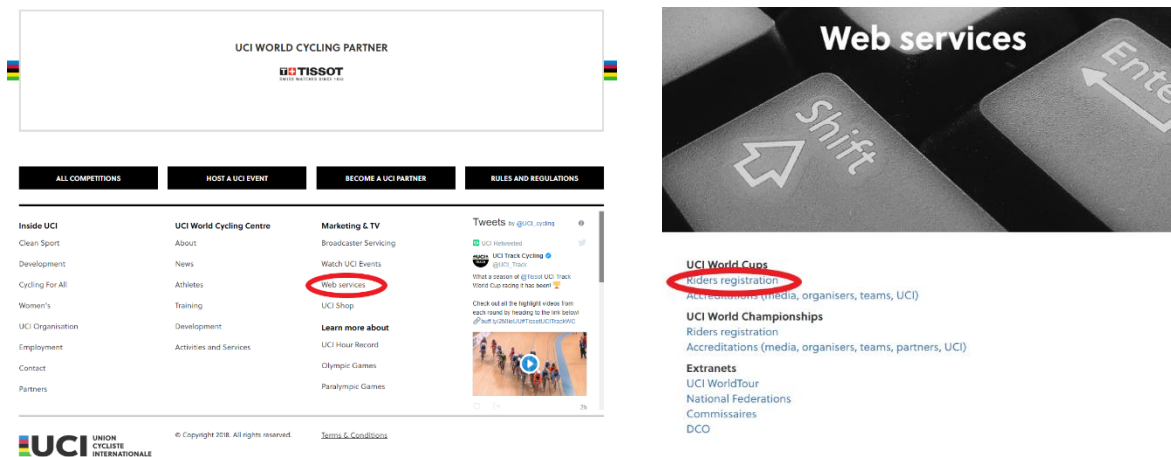

All riders must enter through their National Federation or UCI BMX Team; no individual entries will be accepted. Only Junior and Elite riders can participate at the UCI BMX Supercross World Cup. Registration deadlines are indicated in the General Race Parameters.

http://regonline.uci.ch/layouts/login_Onlineservices.aspx?ReturnUrl=%2f

The name of the hotel where the riders will overnight must be given during the online registration.

The entry fee for the UCI BMX Supercross World Cup is **€250** for online registration.

There is a possibility to prepay by requesting an invoice or to pay in cash or by credit card on site. In case of prepayment, the receipt needs to be taken to the competition. To pre-pay the national federation must contact bmxsupex@britishcycling.org.uk.

Please note pre-payments, if done, must be made so that the entry fee is received into the organisers bank account before rider confirmation starts. If paying electronically Team Managers should bring proof of transfer to Rider confirmation to assist with any issues.

All teams must attend the riders’ confirmation on Friday 26th April between 10.00 and 12.00 presenting their license and picking up their race numbers. Riders not being confirmed before the



indicated deadline did not complete the registration procedure and will not be able to compete at the event.

Riders that were registered through the online system but that are unable to participate will still need to pay their entry fee to the organizer if their registration was not cancelled before the on-line registration deadline.

Late Registration

Late registration is only possible through the National Federation or UCI BMX Team of which the rider is a member. The entry fee for a late registration is € 500 and must be paid immediately on site. Late entries are entries handled after the online registration deadline and before the riders' confirmation deadline, which is Friday 26th April at 12:00h. Once the riders' confirmation deadline has passed, no more late entries will be accepted.

Exchange rate: as per UCI financial obligations:

https://www.uci.org/docs/default-source/financial-obligations/fx-officiel-uci-2019.pdf?sfvrsn=7574cebb_6

4. TEAM BIBS



Team Bibs will be provided for National teams and UCI BMX Teams by the Secretary during the rider's confirmation upon request. Normally 1 bib is available for each team. Larger teams may request a second bib, should supplies allow (subject to confirmation during the Team Managers' meeting).

This takes place during riders' confirmation. Teams will be asked to pay €100 deposit.

The team bibs give access to allocated places explained by the PCP during the team managers meeting. This will include the Team Managers Area at the finish line.

The bibs need to be returned to the Secretary at the end of the competition. You get the deposit back when the bib is returned.

5. RIDER ACCREDITATION

All rainbow passes are delivered to the teams during the first event. If additional sporting passes are necessary, the request needs to be sent before the event to kevin.maccuish@uci.ch. For the request, please indicate the reason, the name and the contact details of the person for whom they are requested.

Rainbow Passes will be distributed during riders' confirmation in the registration room.

6. TEAM MANAGERS MEETING

The Team Managers meeting will take place at the HSBC UK National Cycling Centre in the Track Bank.

- Date: Friday 26th April
- Meeting time: 09:00-09:30
- Location: HSBC UK National Cycling Centre – Track Bank
- All teams should have representation at this meeting.

**7. EVENT SCHEDULE****Event Schedule****Friday 26th April**

- 09.00 - 9.30 Team Manager Meeting
- 10.00 - 12.00 Rider confirmation & transponder handout
- 13.30 - 18.00 Athlete Practice (3x Groups)

Saturday 27th April

- 10.30 - 13.30 Athlete Practice (3 x groups)
- 14.00 - 15.00 Round 1
- 15:00 - 15:05 **Break**
- 15:05 - 15:30 Last Chance Rounds
- 15:30 - 16:00 **Break**
- 16:00 - 16:25 Men 1/16 Finals
- 16:25 - 16:30 **Break**
- 16:30 - 16:45 Women 1/8 Finals
- 16:45 - 17:00 Men 1/8 Finals
- 17:00 - 17:05 **Break**
- 17:05 - 17:15 Women 1/4 Finals
- 17:15 - 17:25 Men 1/4 Finals
- 17:25 - 17:35 **Break**
- 17:35 - 17:45 Women 1/2 Finals
- 17:45 - 17:55 Men 1/2 Finals
- 17:55 - 18:05 **Break**
- 18:05 - 18:15 Women Finals
- 18:15 - 18:25 Men Finals
- 18:25 - 18:40 **Award Ceremony**

Sunday 28th April

- 11.15 - 12.30 Athlete Warn Up
- 13.00 - 14.00 Round 1
- 14:00 - 14:05 **Break**
- 14:05 - 14:30 Last Chance Rounds
- 14:30 - 15:00 **Break**
- 15:00 - 15:25 Men 1/16 Finals
- 15:25 - 15:30 **Break**
- 15:30 - 15:45 Women 1/8 Finals
- 15:45 - 16:00 Men 1/8 Finals
- 16:00 - 16:05 **Break**
- 16:05 - 16:15 Women 1/4 Finals
- 16:15 - 16:25 Men 1/4 Finals
- 16:25 - 16:35 **Break**
- 16:35 - 16:45 Women 1/2 Finals
- 16:45 - 16:55 Men 1/2 Finals
- 16:55 - 17:05 **Break**
- 17:05 - 17:15 Women Finals
- 17:15 - 17:25 Men Finals
- 17:25 - 17:40 **Award Ceremonies**

Event schedule subject to changes

8. TEAM AREAS

In line with other events in the UCI BMX Supercross series team areas will be available to hire.

All **pre booked** team spaces will be indoors, these spaces are positioned underneath the 5m ramp and along the first straight.

Two options are available:

- Small (approx. 9m²)
- Large (approx. 20m²)

Each area includes premium parking, power and WIFI internet access. Spaces will be allocated on a first come first serve basis.

For small teams and individual riders an unreserved area with no power and Wi-Fi will be available.

Teams interested in booking a space may do so by completing the form in Appendix 3 and returning it to bmxsupex@britishcycling.org.uk.

Team Areas will be accessible from 09:00 Friday 26th April until Sunday 28th at 20:00

Power will be available until 30 minutes after the end of competition each day.

Parking on site will be very busy you are not permitted to set up tents/gazebos/structures in the car park or take extra bays for storage of cycles.

The deadline to book is **Friday 12th April 2019** to allow arrangements to be made. Bookings are non-refundable and payment must be received before number plates are distributed.

Teams are not permitted to bring their own structures / tents / gazebos.

9. UCI OFFICIALS

UCI Technical Delegate	Yvan Lapraz (SUI)
President of the Commissaires' panel (PCP)	Maximiliaan Irwan MAGER (SIN)
Assistant PCP	Kjell-Ivar LARSEN (NOR)
Secretary	Christine DECONCLOIS (FRA)
3 rd commissaire	Fulvia TOSI (ITA)
Doping Control Officer (DCO)	Ulf Näslund

10. TRAVEL & ACCOMODATION INFORMATION

The official accommodation provider CSE have secured special accommodation rates at the Holiday Inn Manchester Central Park for teams and other relative personnel.

Team Hotel



Holiday Inn Manchester Central Park
888 Oldham Road
Newton Heath
Manchester
M40 2BS

Website: <http://www.ihg.com/holidayinn/hotels/us/en/manchester/mchcp/hoteldetail>

The Holiday Inn Manchester Central Park is conveniently located less than a mile from the track at the National Cycling Centre and just 2 miles from Manchester City Centre. The modern hotel offers comfortable bedrooms, a bar & restaurant offering a wide range of dining options and 24 hour room service. Guests can also benefit from complimentary onsite car parking & WI-FI access.

To book rooms please contact Mandy at CSE using the contact details below. You can also find the accommodation booking form in the Appendix below.

Please note requests are subject to availability.

CSE Contact Information

Claire.morris@cseplc.com or Nicola.boyle@cseplc.com

Official Hotel

Macdonald Manchester Hotel &Spa

London Road
Manchester
M1 2PG

Website: <http://www.macdonaldhotels.co.uk/our-hotels/macdonald-manchester-hotel-spa>

The Macdonald Hotel & Spa is located in Manchester City Centre, just 3 miles from the National Cycling Centre. The four-star hotel has a bar, a restaurant and offers free Wi-Fi in all guest bedrooms.



Travel

Transfers from the airport are not provided by the LOC, teams are required to make their own travel arrangements to and from the point of arrival

Manchester International Airport

Manchester International Airport is located approximately 11 miles from the HSBC UK National Cycling Centre. There are no direct public transport links from the airport to the national cycling centre, however regular direct trains to Manchester city centre are available.

The train from the airport to the city centre takes approximately 18 minutes with fares starting from £4.20 per person. Links are then available direct to the HSBC UK National Cycling Centre via the Metrolink.

There is also the option for a taxi directly to the HSBC UK National Cycling Centre which would cost approximately £25-£30 sterling for a standard car depending on traffic conditions.

Car or Van Hire

There are many options for Car or Van hire at Manchester International Airport, options are available on the Manchester Airport official website:

<https://www.cartrawler.com/manchesterairport/?clientID=429456>

Ferry Ports

For those driving to the event in order to transport cycling equipment please find below a list of the popular ports and the incoming ferry destinations;

Portsmouth: 240 miles to Manchester:

- Caen, France
- Cherbourg, France
- Jersey
- Guernsey
- Le Havre, France
- Ryde, Isle of Wight
- St Malo, France

Dover: 290 miles to Manchester:

- Calais, France

Liverpool: 35 miles to Manchester:

- Dublin, Northern Ireland
- Belfast, Republic of Ireland



- Isle of Man

Hull: 100 miles to Manchester:

- Rotterdam , Netherlands
- Zeebrugge, Belgium

Rail

Manchester city centre has two major train stations, Manchester Piccadilly and Manchester Victoria. Manchester Piccadilly provides a gateway to the south with direct connections to London Euston every 20 minutes with a journey time of 2 hours. Other major cities within an hour's train journey include; Leeds, Liverpool, Preston and Sheffield.

Metrolink

The Metrolink provides a tram directly from either Manchester Piccadilly or Victoria train stations every 12 minutes to the National Cycling Centre site - the stop for the National Cycling Centre is 'Velopark'. This mode of transport is becoming increasingly popular for those travelling to the track from the train stations as it is simple and often quicker than using taxi's. Please visit the [Metrolink website](http://www.metrolink.co.uk) (<http://www.metrolink.co.uk>) for timetables and further information.

Please note: It is not permitted to take bikes on the Metrolink

11. USEFUL INFORMATION

Key Contacts

If you need further information about the UCI BMX Supercross World Cup, please contact the following persons:

Sport & Technical Aspects:

Kevin MacCuish
BMX coordinator
Kevin.MacCuish@uci.ch

Local Organising Committee:

Beckie Kershaw
British Cycling
beckiekershaw@britishcycling.org.uk

Team Liaison Contact:

Russ Gilston
bmxsuperx@britishcycling.org.uk

Team Liaison

The organising committee has appointed a Team Liaison – Russ Gilston - to act as the main point of contact between participants and the organisers. They can be contacted on the email address above and will be available at the event to answer any enquiries.

Visa

Participants from some countries will need to obtain a visa in order to enter the UK. Should this be the case then we are able to provide you with a letter of invitation to the event in support of your visa application.

Should you need to receive such a letter, please email the following information to

bmxsupex@britishcycling.org.uk

- The full name, nationality, date of birth and passport number of each person that requires a visa.
- Whether the person seeking a visa is team staff or a rider participating in the event.

Please note that due to the uncertainty of Great Britain leaving the European Union in March. Teams needing to obtain a visa should begin the process as early as possible.

Training Opportunities

Indoor practice

In the weeks leading up to competition, the BMX track can be booked for practice. This can be booked through the National Cycling Centre with more information on how to do this [here](#). In addition to track time, you will also be given the opportunity to book rooms, parking and catering.

Practice sessions can be booked on Thursday 25th April between 18:00 – 21:00. The cost will be £25.00 per rider and requests should be made to bmxsuperx@britishcycling.org.uk you will receive an email confirmation if we are able to accommodate your request. If demand requires the organiser will endeavour to extend the practice slot, so please send your requests as soon as possible.

Track Closed: 24th April

For any teams arriving early, there will be **no** training available on the track on Wednesday 24th April, this is due to the setup of the event.

Outdoor practice

There is the possibility to train on a local BMX facility whilst in Manchester – Platt Field BMX

Platt Fields BMX Track is home to the Manchester BMX Club www.manchesterbmx.co.uk

The track is located in Fallowfield, South Manchester approximately 4 miles from the HSBC UK National Cycling Centre. The track is built to British national standard with a 3m hill has a range of technical features and is available for private hire to teams in the lead up to the UCI BMX Supercross World Cup.



To book time and find out more about charges and availability please email emma.harper@gll.org.

**Prize Money - UCI BMX Supercross World Cup – Manchester**

All prize money will be paid electronically within 5 days of the event providing that accurate bank details are provided.

Ranking / Classement	MEN ELITE / HOMMES ELITE		WOMEN ELITE / FEMMES ELITE	
	Per round / Par épreuve	Overall / Général	Per round / Par épreuve	Overall / Général
1st / 1er	2.500 €	10.000 €	2.500 €	10.000 €
2nd / 2ème	1.500 €	6.000 €	1.500 €	6.000 €
3rd / 3ème	1.000 €	4.000 €	1.000 €	4.000 €
4th / 4ème	700 €	1.900 €	700 €	1.900 €
5th / 5ème	550 €	1.600 €	550 €	1.600 €
6th / 6ème	450 €	1.400 €	450 €	1.400 €
7th / 7ème	375 €	1.200 €	375 €	1.200 €
8th / 8ème	325 €	1.000 €	325 €	1.000 €
9th / 9ème		650 €		650 €
10th / 10ème		600 €		600 €
11th / 11ème		500 €		500 €
12th / 12ème		450 €		450 €
13th / 13ème		400 €		400 €
14th / 14ème		350 €		350 €
15th / 15ème		300 €		300 €
16th / 16ème		250 €		250 €
Total	7.400 €	30.600 €	7.400 €	30.600 €
Semi-final 1				
5th / 5ème	275 €		275 €	
6th / 6ème	275 €		275 €	
7th / 7ème	250 €		250 €	
8th / 8ème	250 €		250 €	
Total	1.050 €		1.050 €	
Semi-final 2				
5th / 5ème	275 €		275 €	
6th / 6ème	275 €		275 €	
7th / 7ème	250 €		250 €	
8th / 8ème	250 €		250 €	
Total	1.050 €		1.050 €	

Rider & Team Manager Seating

A reserved standing area will be available for team managers and riders to watch the racing. This will be accessed using an accreditation or wristband. There will also be a small area for Team Managers trackside on the start straight

Please note all general seating is being sold on a reserved basis, therefore there is no seating in the spectator stands for riders and team staff.

During competition accreditation will not grant access to the reserved spectator seating, a ticket will be required. Tickets can be purchased in advance of the event using the

Ticketmaster link: www.ticketmaster.co.uk/britishcycling.

Performance Analysts

A row of seats has been reserved in the grandstand for performance analysts. Each analyst must collect a wristband from the Event Info to be able to access this area during ticketed sessions. The space is very limited and will be provided on a first come first served basis.

Please contact bmxsuperox@britishcycling.org.uk prior to arriving in Manchester to reserve a position.

Media

All media persons planning to attend the event must be accredited in order to gain access to the venue. Media accreditation applications will open closer to the event. For more information and to apply please visit <https://www.britishcycling.org.uk/mediaaccreditation>

Passes will be available to collect from the Event Information Centre which will be open at the following times:

Date	Time
Friday 26 th April 2019	08.30-18:00
Saturday 27 th April 2019	10.00-19:00
Sunday 28 th April 2019	09:00-16:00

Only media with proven significant distribution will be granted media accreditation.

Water

The water from the tap in Great Britain is safe to drink unless stated. There will also be bottled water available for teams and athletes.

Food



**BMX SUPERCROSS
WORLD CUP**

**MANCHESTER
GREAT BRITAIN**

The HSBC UK National Cycling Centre Café is open for most of the event period, located on the ground floor at the front entrance to the centre. Please be aware that during competition breaks this will be very busy.

An athlete catering form will be available for you to pre-order meals when you arrive on site. Please contact bmxsuperox@britishcycling.org.uk if you'd like to receive the form in advance.

Medical Cover

A team of doctors and paramedics will be present throughout practice and racing. The team will be based on the track and also have use of a private medical room throughout the event.

The medical team will be available at the following times:

Official Practice Day

Friday 26th April - 13.00 to 18.00

Competition Days

Saturday 27th April - 10.00 to 18.30

Sunday 28th April - 09.00 to 17.30

The nominated hospitals are as follows.

Neurological

Salford Royal, Stott Lane, Salford, M6 8HD

0161 780 7373

Accident & Emergency

Manchester Royal Infirmary, Oxford Road, Manchester, M13 9WL

Tel: 0161 276 1234

An ambulance is on site to transfer very serious injuries to hospital, we ask that teams help ensure this resource is only utilised in serious circumstances by transferring athletes to hospital in their own vehicles wherever possible.

11. ABOUT MANCHESTER

Manchester is now one of the most successful and well known cities in Europe notably for its architecture, culture, music scene, media links, scientific and engineering output and sporting connections.

It is a city of firsts, driven by people who produce results and get things done. There was a phrase coined in Victorian times, 'What Manchester does today, the world does tomorrow', and with just cause. Manchester was the first city of the industrial revolution, sparking a new way of doing things that literally changed the world and are now embarking on sharing Graphene, its latest discovery, with the world.

Manchester is a globally recognised sports capital that has secured its place as an international destination for leisure, tourism and business and has rightfully gained a reputation as a place that makes things happen.

Manchester boasts world-class sporting facilities, an ever-growing sports development programme, a diverse major sports events portfolio and crucially, a network of partners whom we cooperate with on a number of levels

Manchester's events strategy outlines the commitment to maximising the benefits for its residents, businesses and visitors through the staging of world class sports events. Manchester also prides itself in being able to connect its events to its communities and partners not only regularly distributing thousands of event tickets to North West schools and colleges, sports clubs and charitable organisations, but linking numerous legacy activities with events.

Manchester offers a wide range of accommodation and a trusted public transport network system which is constantly being improved, with easy methods of connectivity to and from the city by air, rail and roads.

The digital connectivity of Manchester ranks amongst the best in the world with Media City UK at Salford—home to the BBC and Manchester Digital Hub boasting Europe's second largest creative, digital and media hub.

Manchester has an undisputable passion for sport, one that will ensure that the city's round of the 2019 UCI BMX Supercross World Cup will be the most exciting and entertaining BMX event possible.

For more information about Manchester and the shopping, nightlife and attractions the city has to offer, go to visitmanchester.com

APPENDIX 1 – VENUE LAYOUT

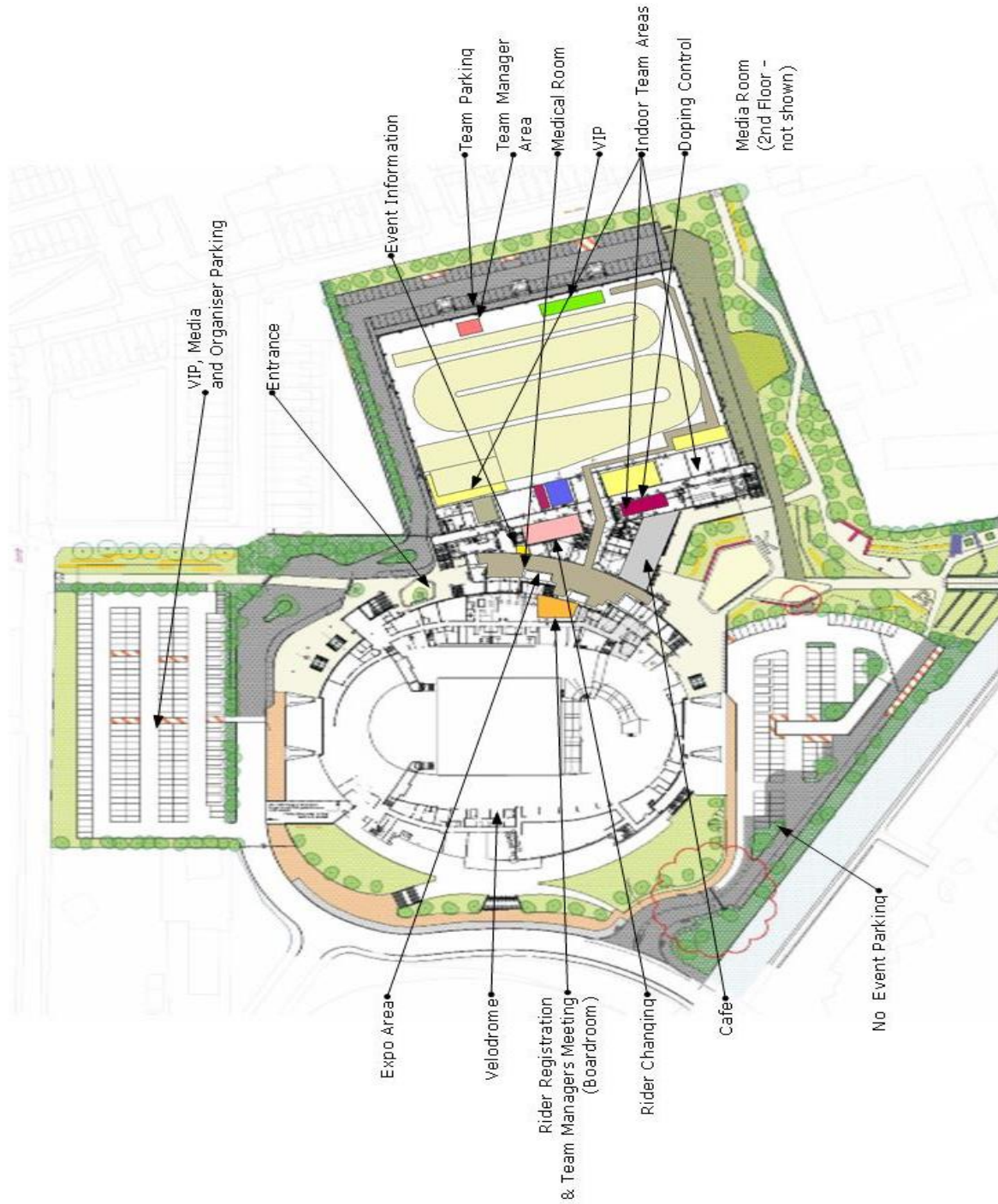



APPENDIX 2 - TEAM AREA BOOKING FORM

Personal Details

NATION/TEAM (For Invoice):	
APPROXIMATE TEAM SIZE (please circle)	0-5 6-10 11-15 16-20 21+
CONTACT NAME:	
TELEPHONE (Inc Int Code):	
EMAIL:	
ADDRESS:	

Rates

Size	Cost	Please Tick
Small space (approx. 9m ²) + premium parking for 1 vehicle	£250	
Large space (approx. 20m ²) + premium parking for 1 vehicle	£500	

All pre-booked small and large spaces are **indoors**, close to the track and include power and internet access.

For small teams and individual riders there is an unreserved area but this does not include power and Wi-Fi. Parking for vehicles is located further away from the track.

1. The area booked is the maximum space that can be used. Teams must check in with the team liaison coordinator Russ Gilston on arrival.
2. Vehicle access and parking passes will be allocated according to the area booked.
3. Teams will receive confirmation of receipt of booking form however; final confirmation of space will not be until full payment is received.
4. Positions will be allocated on a first come first serve basis.
5. **Teams are not permitted to bring their own structures.**



BMX SUPERCROSS WORLD CUP

MANCHESTER, 27 APRIL – 28 APRIL 2019

CSE are pleased to offer teams the special accommodation packages shown below:

TEAM NAME:		LEAD NAME:	
ADDRESS:			
TEL:		EMAIL:	

ACCOMMODATION REQUEST

HOTEL	STANDARD	SINGLE ROOM RATE <small>PER PERSON</small>	TWIN ROOM RATE <small>PER PERSON</small>
Crowne Plaza Oxford Road Hotel		GBP 125.00	GBP 67.50
The Victoria Hotel		GBP 105.00	GBP 67.50
Holiday Inn Central Park Hotel		GBP 115.00	GBP 63.00

ROOM RATES INCLUDE: Buffet Breakfast and VAT

REQUESTED HOTEL: _____

Please complete the amount of rooms required each night below:

	THU 25 APR	FRI 26 APR	SAT 27 APR	SUN 28 APR	MON 29 APR
SINGLE ROOMS:					
TWIN ROOMS:					
	THU 25 APR	FRI 26 APR	SAT 27 APR	SUN 28 APR	MON 29 APR
SINGLE ROOMS:					
TWIN ROOMS:					

PAYMENT

Should you wish to pay for your booking by credit card please complete your details below:

CARD TYPE:	VISA CREDIT	MASTERCARD	VISA DEBIT	AMEX	SIGNATURE: DATE:
CARD NUMBER:					
EXPIRY DATE:					
3 DIGIT SECURITY NUMBER:					
CARDHOLDER NAME:					

Should you wish to pay by bank transfer, our bank account details will be provided upon request.

PAYMENT BY BANK TRANSFER	YES	NO
---------------------------------	-----	----

PRIVACY NOTICE/POLICY – CSE have revised our Privacy Notice to comply with the GDPR, ensuring that all individuals whose personal information we process have been informed of why we need it, how it is used, and that all personal information will be destroyed, and safeguarding measures are in place to protect their information.